

# dexcomG6

## START HERE

Set up

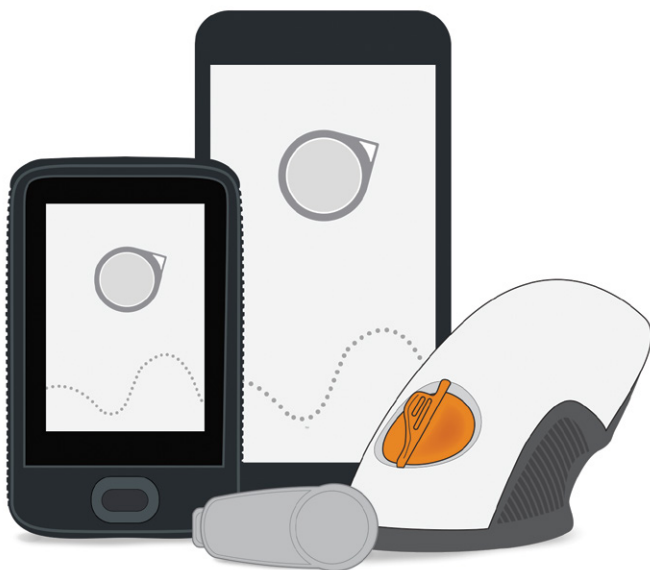

Instructions For Use

# Dexcom G6 CGM (G6) Overview

## Display Device

- Shows glucose information
- Set up your smart device, Dexcom receiver, or both
- For a list of current compatible smart devices and operating systems go to: [dexcom.com/dexcom-international-compatibility](https://dexcom.com/dexcom-international-compatibility)
- The Dexcom G6 app and receiver are compatible with all G6 systems.

Your smart device

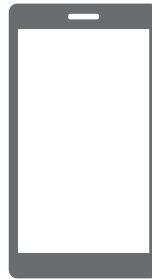

Dexcom receiver



## Applicator With Built-in Sensor

- Sensor applicator inserts sensor under your skin
- Sensor gets glucose information.

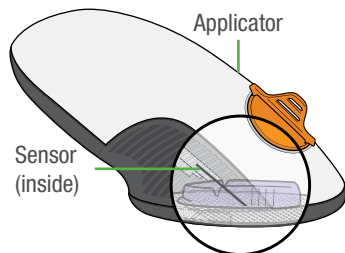

## Transmitter

- Sends glucose information from sensor to display device.

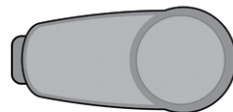

All graphics are representational. Your product may look different.

Review the Safety Statement in *Using Your G6*, Chapter 2 before using your Dexcom G6.

# What It Does

The Dexcom G6 sends G6 sensor glucose readings to your display device.



## Choose App, Receiver, or Both

The receiver is a dedicated medical device. Your smart device is not, even though you can run the Dexcom G6 app on it. Your smart device is not a dedicated medical device because the app could miss an alarm/alert just because it is on a smart device—for example, due to smart device settings, smart device or app shutting off, low battery, etc.

### Use tabs below to set up the app, receiver, or both

Want to set up both? Pick one to set up first and turn to that tab. The last step shows you how to set up the second display device. Do not use both tabs.

For other ways to learn how to set up your Dexcom G6:

- Watch the tutorial at: [dexcom.com/downloadsandguides](https://dexcom.com/downloadsandguides)
- Contact your local Dexcom representative for support.



Your smart device



Dexcom receiver

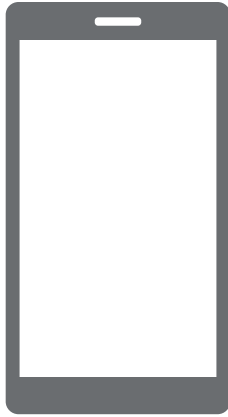

Your smart device

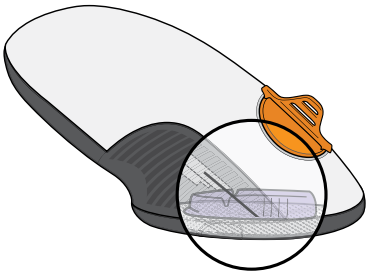

Applicator with  
Built-in Sensor

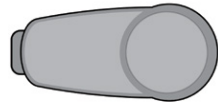

Transmitter

**Set Up App**

# Step 1: Set Up App

## A Download and open the Dexcom G6 app



## B Follow on-screen set up instructions

### 1 When prompted:

- Send your data to the cloud.  
This lets you use:
  - Share: Send your Dexcom G6 data to followers
  - CLARITY: Reflect on data with doctors; see patterns (may not available in all regions).
- Enter your Sensor code  
(from the sensor applicator you will insert)
  - No sensor code?  
See *Using Your G6, Appendix A Troubleshooting*.

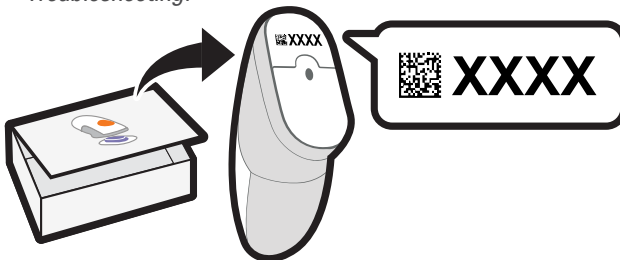
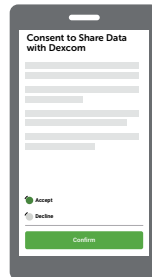

- Enter your Transmitter Serial Number (SN) from:

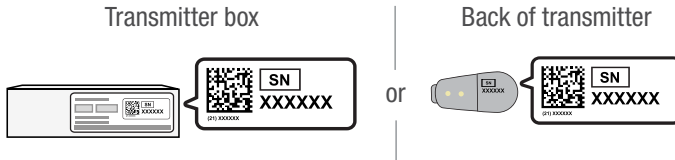

After you enter your SN, your Dexcom G6 searches for the transmitter. While it is searching, you will not get readings or alarm/alerts.

- 2** Insert sensor and transmitter.  
**Follow instructions on page 10-12 in this guide.**

- 3** See the blue sensor warmup timer?  
That means your sensor is getting used to your body.

During warmup:

- No readings or alarm/alerts
- Always keep smart device within 6 meters of transmitter.



## **C** Wait 2 hours

- When sensor warm-up is complete, tap **OK** to see the home screen
- Now you get readings and alarm/alerts.

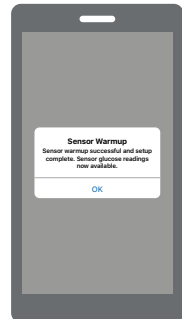

## Step 2: See *Using Your G6*

Learn how to:

- Read your home screen
- Use alarm and alerts
- Make treatment decisions
- Troubleshoot issues

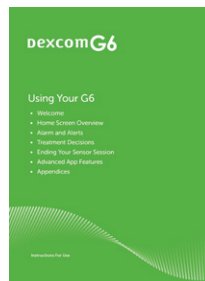

## Step 3: Optional – Set up Receiver

Turn on the receiver by pressing the power button down for 2-3 seconds. Then, follow on-screen instructions.

Do not use the Set Up Receiver tab. Those steps are for setting up the receiver before setting up the app.

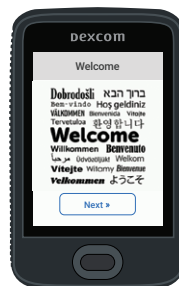

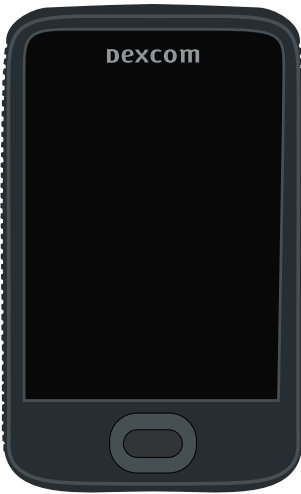

Receiver

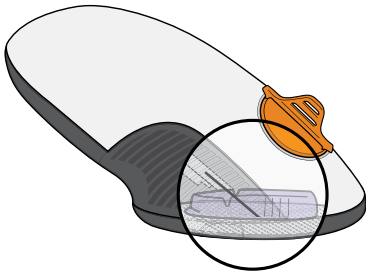

Applicator with  
Built-in Sensor

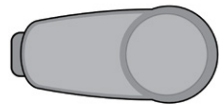

Transmitter

## Set Up Receiver



# Step 1: Set Up Receiver

## A Take receiver out of box



## B Turn on receiver

Press power button for 2-3 seconds.



## C Follow on-screen instructions

- 1 When prompted, enter your:
  - Sensor code from the sensor applicator you will insert
  - No sensor code?  
*See Using Your G6, Appendix A Troubleshooting.*

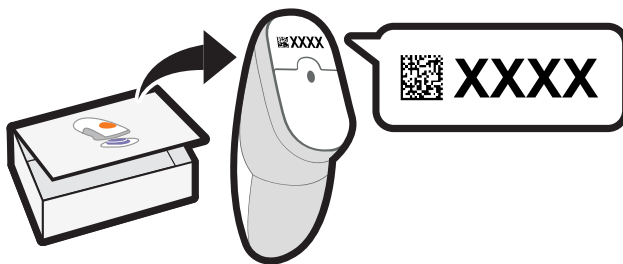

- Transmitter Serial Number (SN) from:

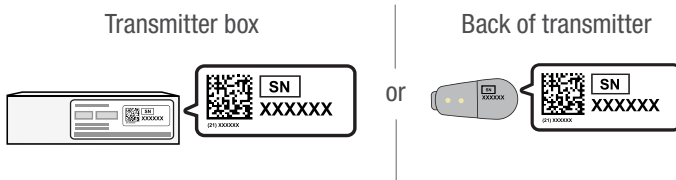

After you enter your SN, your Dexcom G6 searches for the transmitter. While it is searching, you will not get readings or alarm/alerts.

- 2** You are done with this step when you see this screen:

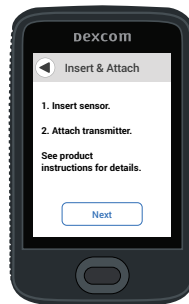

# Step 2: Use Applicator to Insert Built-in Sensor

## A Take applicator with built-in sensor out of sensor box

Gather materials: applicator (with code you just entered), transmitter and alcohol wipes.

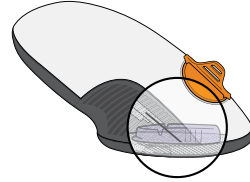

## B Pick sensor site

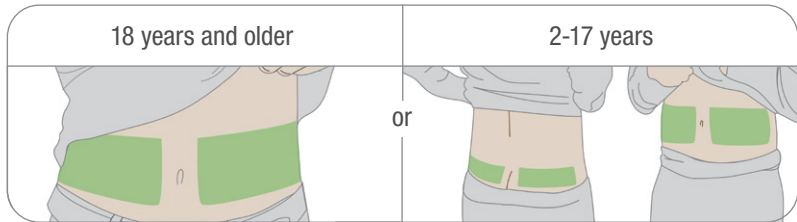

Avoid bones, irritated skin, tattoos, and areas that get bumped.

## C Use applicator to insert built-in sensor

**1** Get sensor applicator and an alcohol wipe.

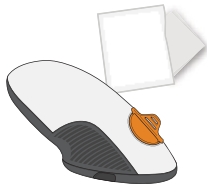

**2** Wash and dry hands.

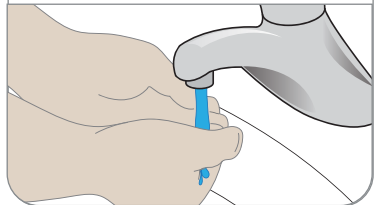

**3** Clean sensor site with alcohol wipe.

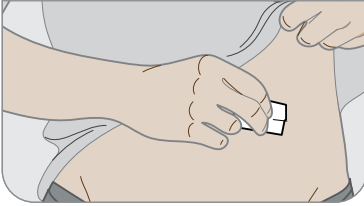

**4** Peel off adhesive backings. Do not touch adhesive.

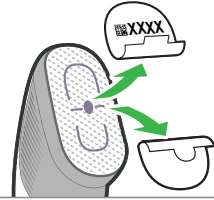

**5** Place applicator on skin.

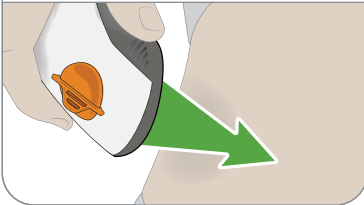

**6** Fold and break off safety guard.

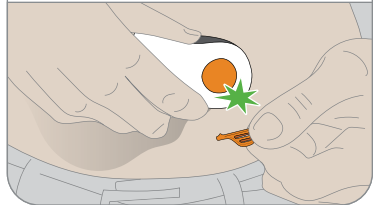

**7** Press button to insert sensor.

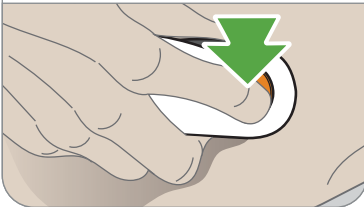

**8** Remove applicator from skin leaving patch and holder on.

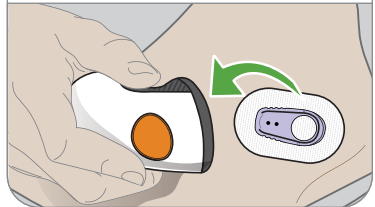

**9** Discard applicator. Follow local guidelines for blood-contacting components.

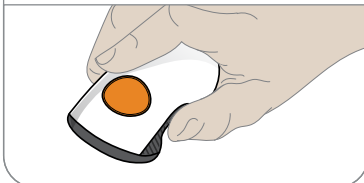

# Step 3: Attach Transmitter

## A Take transmitter out of box

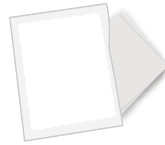
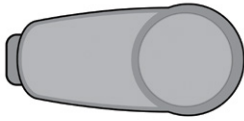

## B Snap in transmitter

**1** Clean transmitter with alcohol wipe.

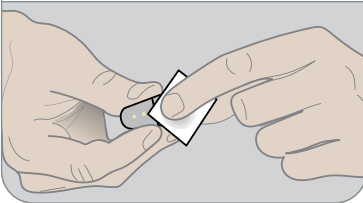

**2** Insert transmitter, tab first, into holder.

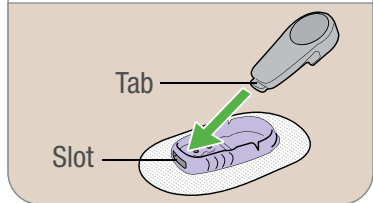

**3** Snap in transmitter. It clicks into place. Make sure it is flat and snug in holder.

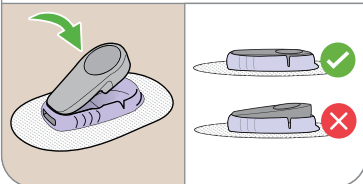

**4** Rub around patch 3 times.

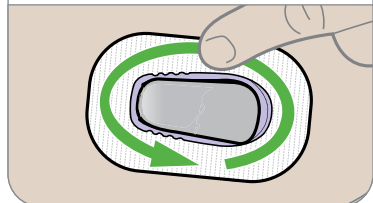

# Step 4: Start Sensor on Receiver

## A Wait up to 30 minutes for pairing

During pairing:

- No readings or alarm/alerts
- Always keep receiver within 6 meters of transmitter.



## B Tap Start Sensor to begin 2-hour warmup

During warm-up you will not get readings or alarm/alerts.

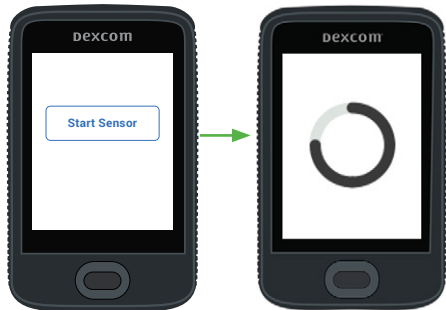

## C Wait

- When complete, tap **Next** to go to home screen
- Now you get readings and alarm/alerts.



## Step 5: See *Using Your G6*

Learn how to:

- Read your home screen
- Use alarm and alerts
- Make treatment decisions
- Troubleshoot issues

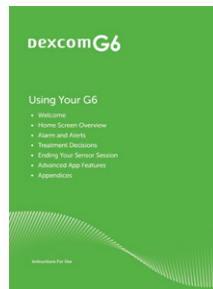

## Step 6: Optional - Set up App

Download the app onto your smart device and open it. Then follow onscreen instructions.

Do not use the Set Up App tab. Those steps are for setting up the app before setting up the receiver.



# Dexcom



Dexcom, Inc.  
6340 Sequence Drive  
San Diego, CA 92121 USA

+1.858.200.0200

dexcom.com

CE  
2797

For more information on Dexcom G6 CGM, please contact us on **1300 851 056**  
or at [diabetes@amsl.com.au](mailto:diabetes@amsl.com.au)

[amsldiabetes.com.au](http://amsldiabetes.com.au)



© 2020 Dexcom, Inc. All rights reserved. Covered by patents [dexcom.com/patents](http://dexcom.com/patents). Dexcom, Dexcom G6 and Dexcom Share are registered trademarks of Dexcom, Inc. in the United States and/or other countries. ARTG 330535. MT26357 April 2020